

A scenic landscape featuring a river in the foreground, a grassy bank with several trees, and a large tree on the right side. The scene is bathed in soft, natural light, suggesting a peaceful outdoor setting.

# WELCOME

River Task Force Meeting

April 27, 2023

# Development Team

Developer



**OBORAN**



Landscape Architect



Environmental Consultant



Construction Manager



Earthwork Contractors





# River Park - Site Constraints

# Northville's River Park

*"What attracts people most, it would appear, is other people." – William H. Whyte, Urbanist, Sociologist, Author*

## Design Objectives

- Transform a blighted piece of land into a usable community and regional asset
- Provide a passive and naturalized park for recreational use as an extension of Hines Park
- Create an interconnected and comprehensive pedestrian and bicycle network
  - to Downtown
  - to adjacent neighborhoods
  - to the river
  - to Hines Park
- Reopen roughly 1/4 mile of the Rouge River
- Provide a river design capturing the floodplain within the banks
- Integrate the stormwater management pond with river park
- Preserve the River Street right-of-way for possible future improvements

## Design Concept

- Organic
- Walkable
- Flexible
- Passive recreation
- Community gathering
- Serene landscape

# Northville's River Park

*"What attracts people most, it would appear, is other people." – William H. Whyte, Urbanist, Sociologist, Author*



# Northville's River Park

*"What attracts people most, it would appear, is other people." – William H. Whyte, Urbanist, Sociologist, Author*

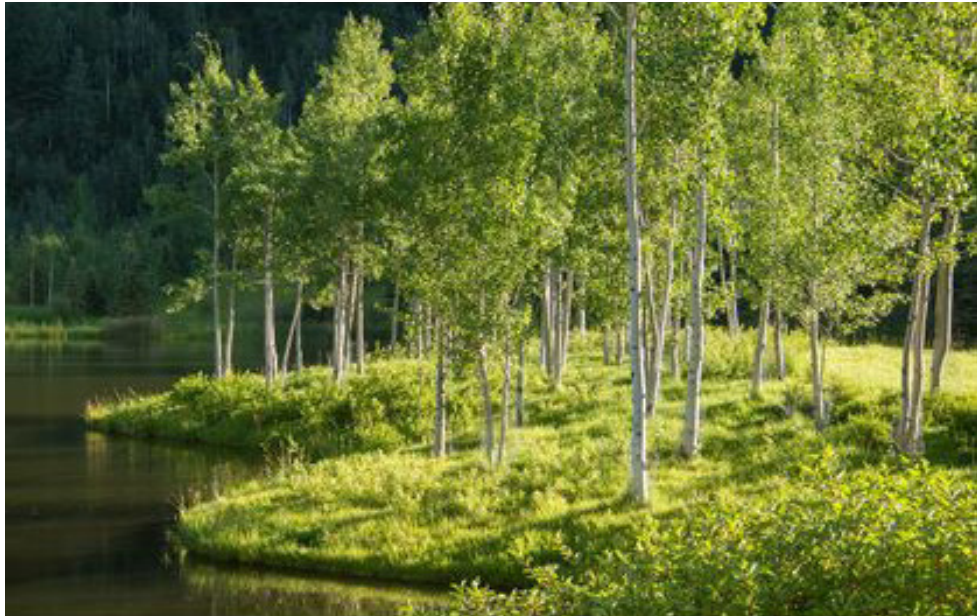
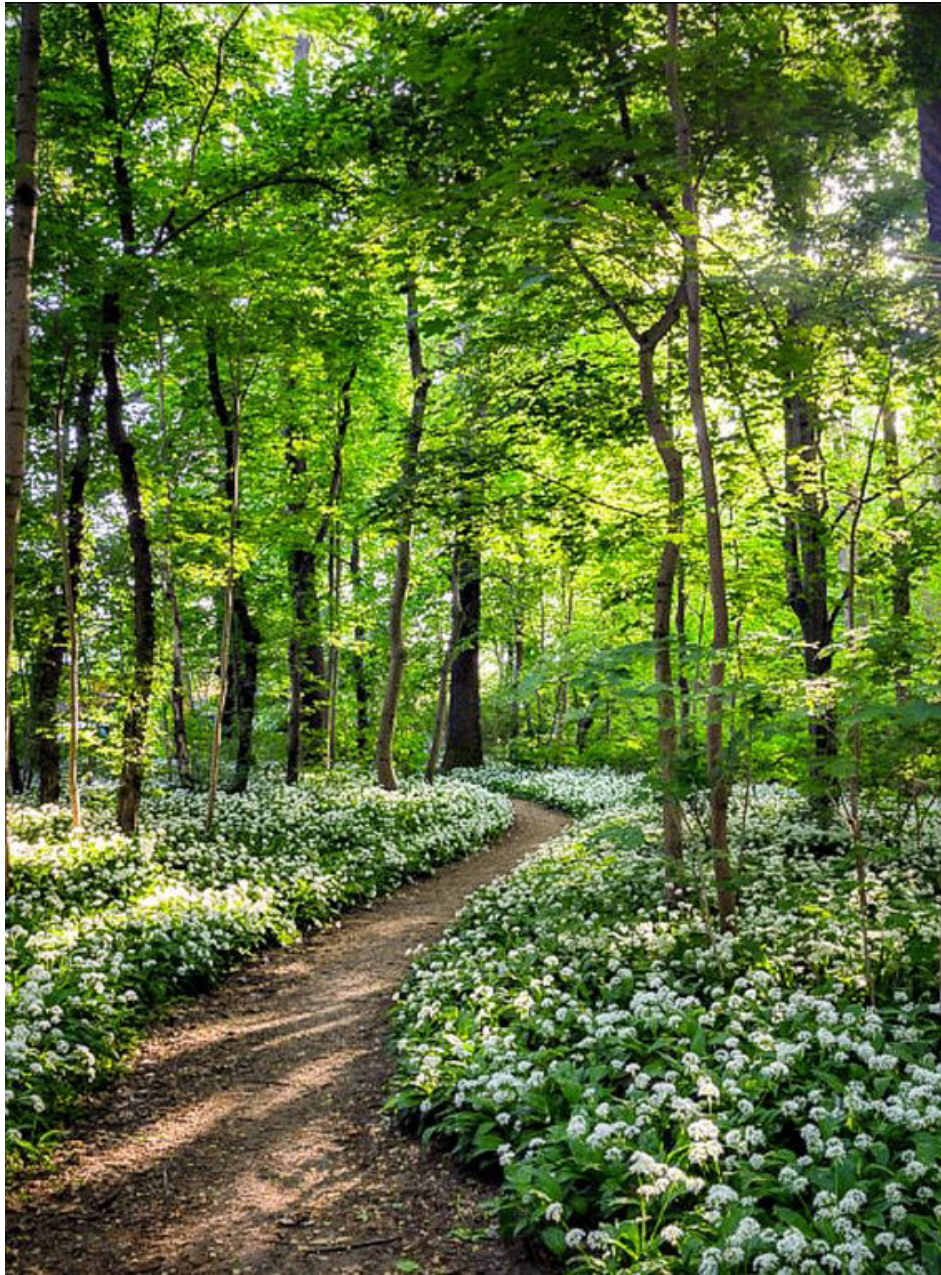

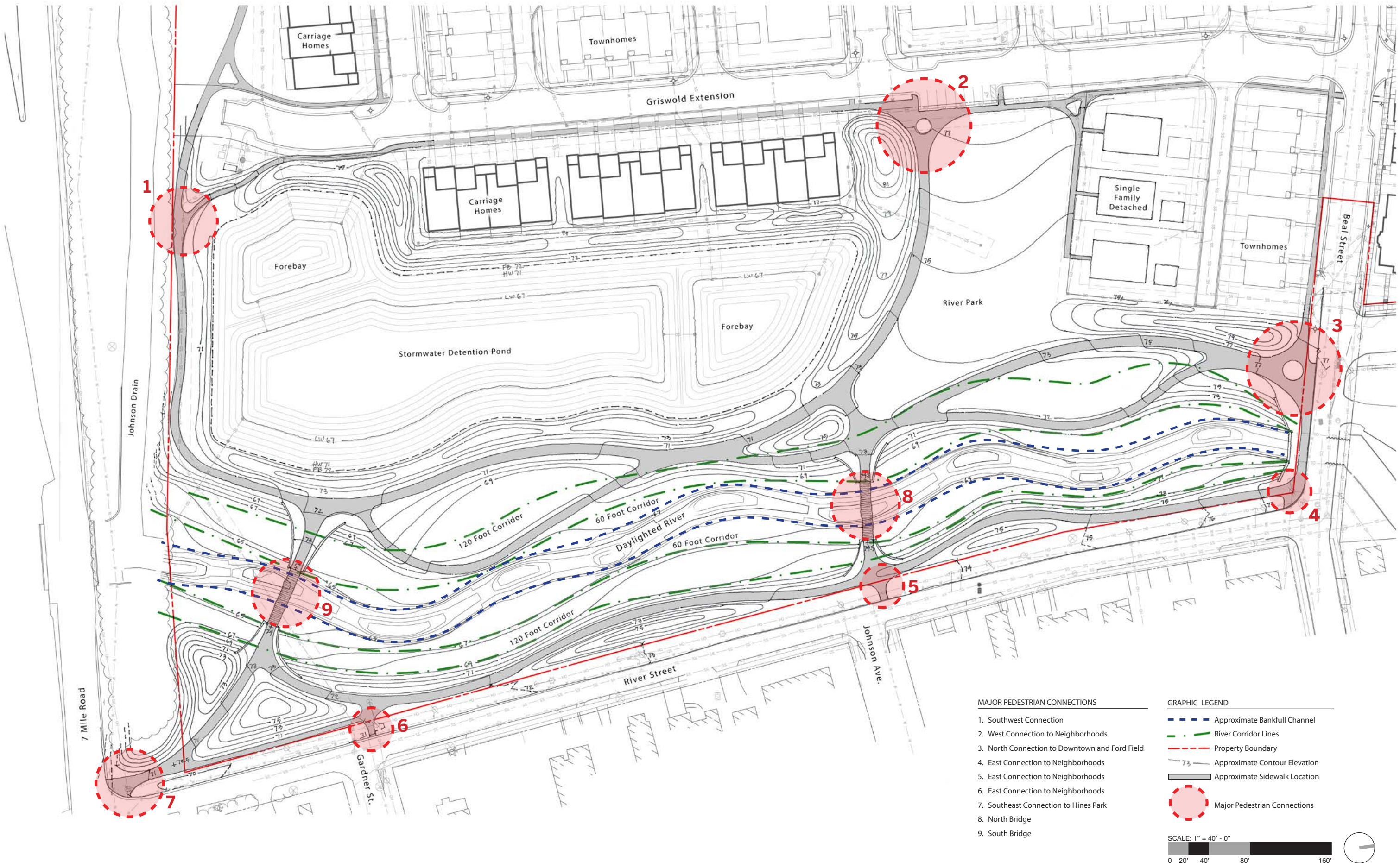

**MAJOR PEDESTRIAN CONNECTIONS**

1. Southwest Connection
2. West Connection to Neighborhoods
3. North Connection to Downtown and Ford Field
4. East Connection to Neighborhoods
5. East Connection to Neighborhoods
6. East Connection to Neighborhoods
7. Southeast Connection to Hines Park
8. North Bridge
9. South Bridge

**GRAPHIC LEGEND**

- Approximate Bankfull Channel
- River Corridor Lines
- Property Boundary
- Approximate Contour Elevation
- Approximate Sidewalk Location
- Major Pedestrian Connections





**NOTE KEY**

- |  |  |
|--|--|
| ① Gathering Space at Bridge Access                           | ⑭ Berming with Trees for Landscape Separation                                |
| ② 10' Wide Pedestrian Bridge with Wing Walls                 | ⑮ Ornamental Trees   |
| ③ Aerator Fountains  | ⑯ Relocated Cabin  |
| ④ Upper Level Pedestrian Network                             | ⑰ Trash Receptacle   |
| ⑤ Lower Level Pedestrian Network                             | ⑱ Wayfinding Sign  |
| ⑥ Connection to Hines Park Trailhead                         | ⑲ River Bank Plantings   |
| ⑦ Park Lighting (+/- 150' on Center)                         | ⑳ Lawn with Existing Trees in River Street Right-of-way (trees to be pruned) |
| ⑧ Park Benches   | ㉑ Aquatic Planting Pockets   |
| ⑨ Bike Repair Station, Bike Racks and Drinking Fountain      | ㉒ Area of "Rapids" in River  |
| ⑩ Berming and Evergreen Screening Adjacent to Residential    | ㉓ Densely Planted Tree Zones Along River Bank                                |
| ⑪ Usable Cut Lawn Areas                                      | ㉔ Meadow Lawn  |
| ⑫ Low Berms with Tree Massings Along River Street            |  |
| ⑬ Seed Mixes and Plant Types Similar to River Bank Landscape |  |





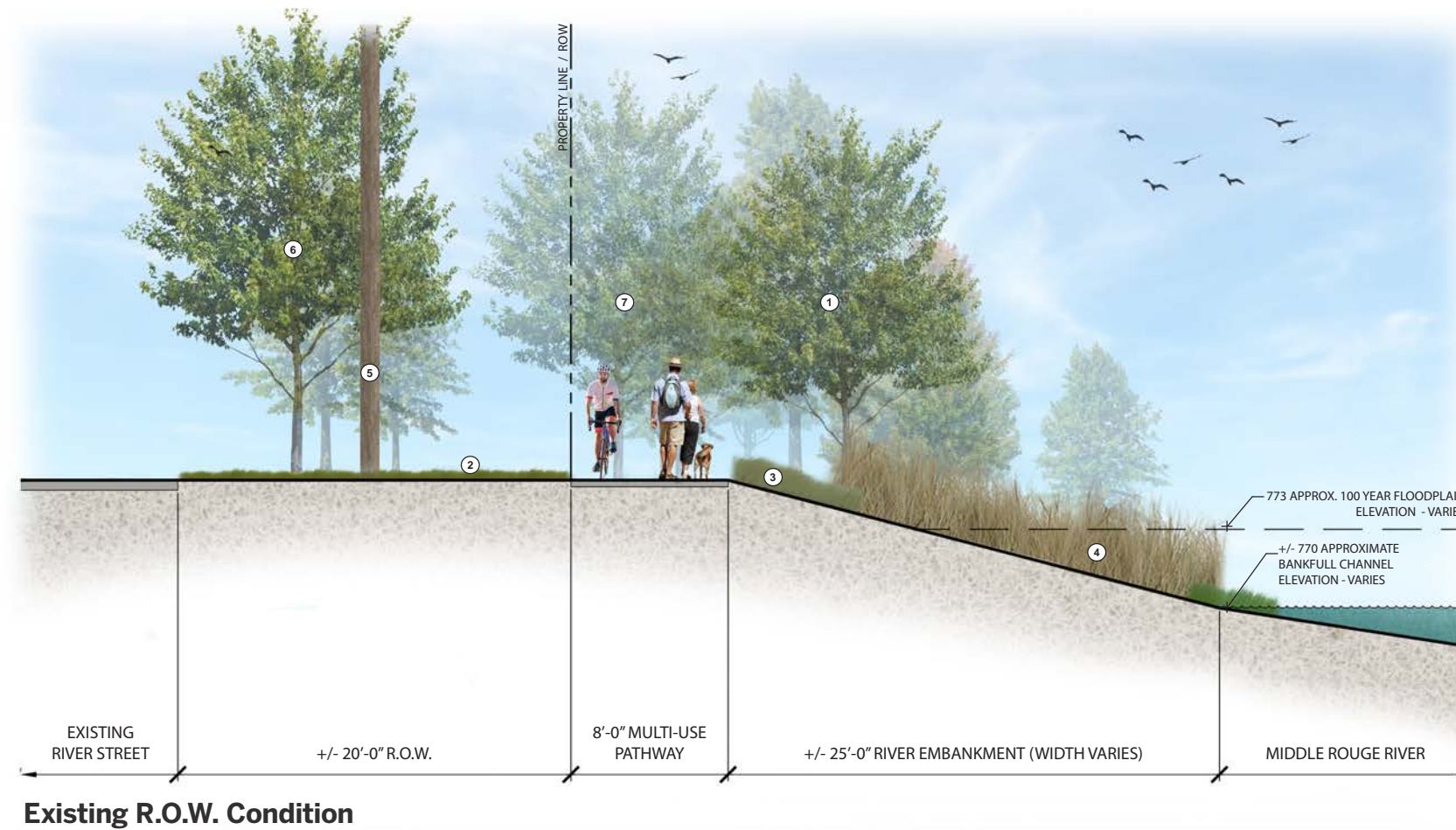

- NOTE KEY**
- ① Varying Types and Sizes of Deciduous Trees
  - ② Cut Lawn
  - ③ Meadow Lawn (+/- 1'-0" tall)
  - ④ Riverbank Native Seed Mixes
  - ⑤ Existing Utility Poles
  - ⑥ Existing Trees in R.O.W. to be Pruned
  - ⑦ Trees Beyond on Berm as Pathway Swings into Site



NOTE KEY

- ① Varying Types and Sizes of Deciduous Trees
- ② Cut Lawn
- ③ Meadow Lawn (+/- 1'-0" tall)
- ④ Riverbank Native Seed Mixes
- ⑤ Existing Utility Poles
- ⑥ Existing Trees in R.O.W. to be Pruned
- ⑦ Trees Beyond on Berm as Pathway Swings into Site



Bike Repair Station



Lighting, Way Finding and Trash



Benches



Bike Racks



Basswood



Hackberry



Kentucky Coffee-tree



Heritage River Birch



Bur Oak



Swamp White Oak



Pin Oak



Red Oak



Red Maple



Suger Maple



Muscledwood



Sycamore



Norway Spruce



Serbian Spruce



White Spruce



White Pine



Concolor Fir



Crabapple



Crabapple



Redbud



Magnolia



Serviceberry

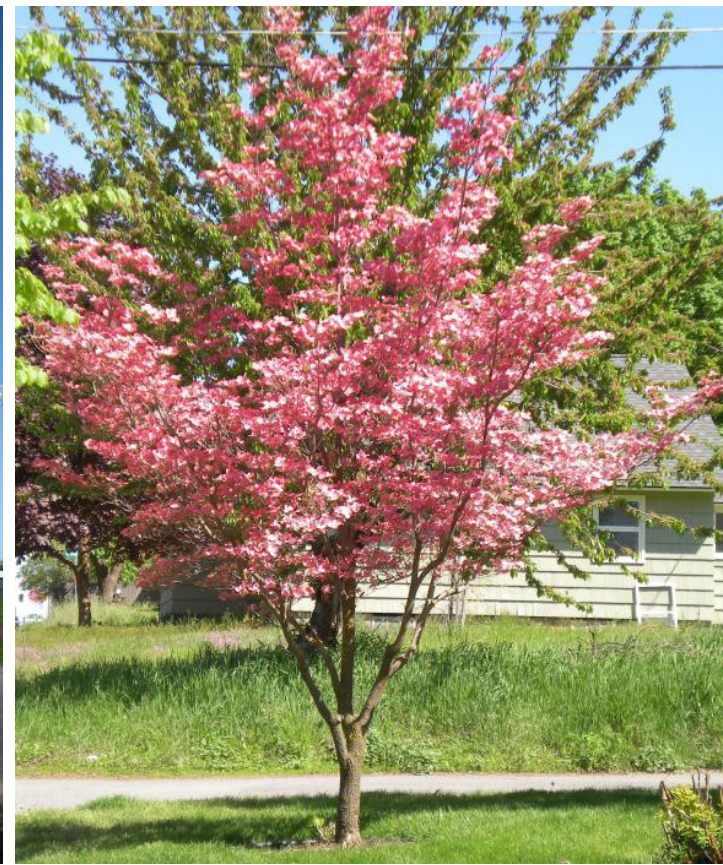

Dogwood



Dogwood

A scenic landscape featuring a river flowing through a lush green area. The river is surrounded by tall grasses and various trees, including a large tree on the left. In the background, a bridge spans across the river. The sky is blue with some clouds. The overall scene is peaceful and natural.

# THANK YOU

[ndinput@hunterpasteurhomes.com](mailto:ndinput@hunterpasteurhomes.com)  
[northvilledowns.info](http://northvilledowns.info)